



a TKH Vision brand

EXO USB3 Vision

exo4000CU3

The SVCam EXO is one of the most flexible and scalable cameras for the industrial market segment. The USB3 Vision interface is easy to integrate in your system, with a data rate up to effective 360 MB/sec. The time to market for applications is shortened, saving cost even further. Power the camera via the interface and reduce cable complexity.

Technical Highlights

- Up to 360 MB/s effective transfer rate
- Leverages existing infrastructure for cables and connectors
- Powers camera with up to 4.5 W
- GenICam compliant
- Cost effective / Easy implementation and interfacing



LED
4 INTEGRATED
LED-CONTROLLERS

SEQ
INTEGRATED
SEQUENCER

STT
SAFE TRIGGER
TECHNOLOGY

PLC
PROGRAMMABLE
LOGIC CONTROL

CHAT WITH US



Specifications

| | |
|--------------------|---------------------|
| Resolution [MP] | 4 MP |
| Resolution (h x v) | 2048 x 2048 px |
| Frame rate (max.) | 74 fps |
| Chroma | color |
| Interface | USB3.0 (Micro-B) |

Sensor

| | |
|---------------------|-------------------|
| Sensor | CMV4000-3E5C1PP |
| Manufacturer | CMOSIS |
| Sensor type | Area CMOS |
| Shutter type | global shutter |
| Sensor size (h x v) | 11.26 x 11.26 mm |
| Optical diagonal | 15.93 mm |
| Sensor format | 15.9mm (1") |
| Pixel size (h x v) | 5.5 x 5.5 μ m |

Camera

| | |
|---------------------|--------------------------------|
| Exposure modes | MANUAL;AUTO;EXTERNAL |
| Trigger modes | INTERNAL;SOFTWARE;EXTERNAL |
| Exposure time (min) | 27 μ s |
| Exposure time (max) | 60 sec (external ∞) |
| Pixel format / max | bayer8, bayer12packed / 12 bit |
| Gain modes / max | manual, auto / 11 dB |
| S/N ratio (max) | 38 dB (dep. on environment) |
| Dynamic range (max) | 52 dB (dep. on environment) |
| Internal memory | 256 MB SDRAM, 32 MB Flash |

Feature Set

| | |
|-------------------------|-----|
| Manual white balance | yes |
| Automatic white balance | yes |
| AOI | yes |
| LUT | yes |
| Binning | yes |
| Image flip | yes |
| Shading correction | yes |
| Defect pixel correction | yes |
| Sequencer | yes |

Housing

| | |
|------------------------|-----------------------------|
| Lens mount | C-Mount |
| Dimensions (w x h x d) | 50 x 50 x 47.1 mm |
| Weight | 138 g |
| Ambient temperature | -10 to 45 °C |
| Ambient humidity | 10 to 90 % (non-condensing) |
| Protection class | IP40 |
| Filter-/Coverglass | IR-Cut - 680nm |

I/O-Interfaces

| | |
|-------------------|--------------------------------|
| Input up to 24V | 2 x |
| Input OPTO | 1 x |
| Output open drain | 4 x |
| I/O RS-232 | 1 x |
| Power supply | 10 to 25 V (DC) |
| Power consumption | 4.5 W (dep. on operating mode) |

front

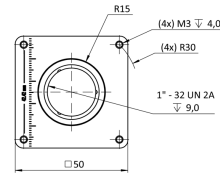

back

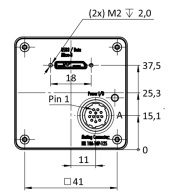

cross section

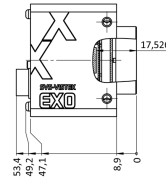

right side

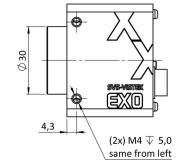

top

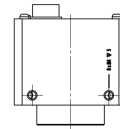

bottom

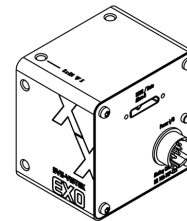
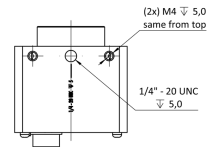

Pinout Mating Connector

Hirose 12 Pin

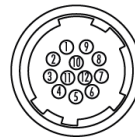

| | | | |
|---|-------------------------|----|--------------------|
| 1 | VIN - (GND) | 7 | OUT 1 (open drain) |
| 2 | VIN + (10 V to 25 V DC) | 8 | OUT 2 (open drain) |
| 3 | IN 4 (RXD RS232) | 9 | IN 3 + (opto In +) |
| 4 | OUT 4 (TXD RS232) | 10 | IN 3 - (opto In -) |
| 5 | IN 1 (0 - 24V) | 11 | OUT 3 (open drain) |
| 6 | IN 2 (0 - 24V) | 12 | OUT 0 (open drain) |

Spectral Response *

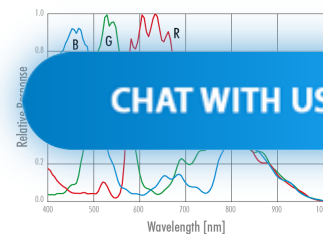

* Sensor data – excludes camera cover- or IR-cut filter characteristics

SVS-VISTEK GMBH

© 2024-2025 SVS-Vistek GmbH

Ferdinand-Porsche-Str. 3 82205 Gilching Germany phone +49 8105 3987-60 info@svs-vistek.com

CHAT WITH US

